

# A4LD

## Automatic Transmission



### Options

- **Slip Yoke** with 25 teeth for size 1310 u-joints

### Approximate Dimensions

Width

14.7 inches (373 mm)

Height

14.8 inches (376 mm)

Face to Mount

25.5 inches (648 mm)

Length

34.6 inches (879 mm)

Face to Control Lever

16.3 inches (414 mm)

Bolt Pattern

Ford LRG-425

### Warranty

Contact Ford Power Products for warranty details.

### Specifications

Transmission Type	.Hydraulically Controlled
Torque Capacity	.445 Ft-Lb. (600 Nm) after converter
Torque Capacity (235K)	.174 Ft-Lb. (234 Nm) before converter
Converter Stall Torque	
Multiplication	.2.56:1
Maximum Fluid Temp	.250 degrees F (121 degrees C)
Continuous	.220 degrees F (104 degrees C)
Installation Angle	.5.5 degrees
Weight with Oil	.147 lb. (67 kg)
Transmission Fluid	.Mercon
Fluid Capacity	.9.5 quarts (9.0 litres)
Engine Usage	.Ford LRG-425

### Gear Ratios

First Gear	.2.474 to 1.00
Second Gear	.1.474 to 1.00
Third Gear	.1.000 to 1.00
Reverse Gear	.2.111 to 1.00

### Gear Range Selection

Available Positions . . . . . P-R-N-D-3-2-1

### Transmission Controller

Type . . . . .Hydraulic Valve Body

### Standard Features / Benefits

**Manual First** with engine braking

**Manual Second** with engine braking

**Engine Braking Drive Position** with engine braking in first, second and third gears when the gear selector is in the "3" position

**Free-Wheeling Drive Position** with no engine braking in first, second or third gears when the gear selector is in the "D" position

**Built-in Neutral Safety Start** and **Reverse Light Switch**

**Over-Speed Downshift Protection** preventing damage when manually shifting into first or second gear

**Manual Kick-Down Lever** providing lower gear selection at higher vehicle speeds



The Source for Power...  
Worldwide™

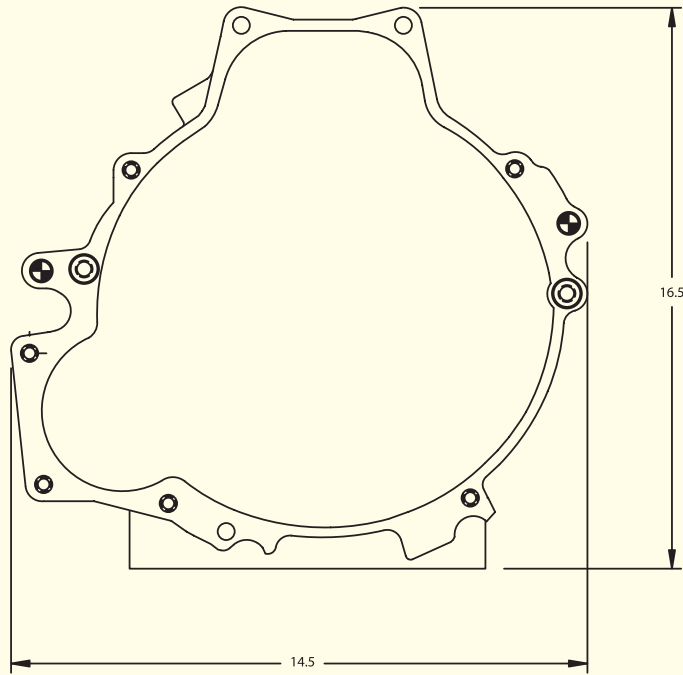

**Front End View**

Measurements	in
--------------	----

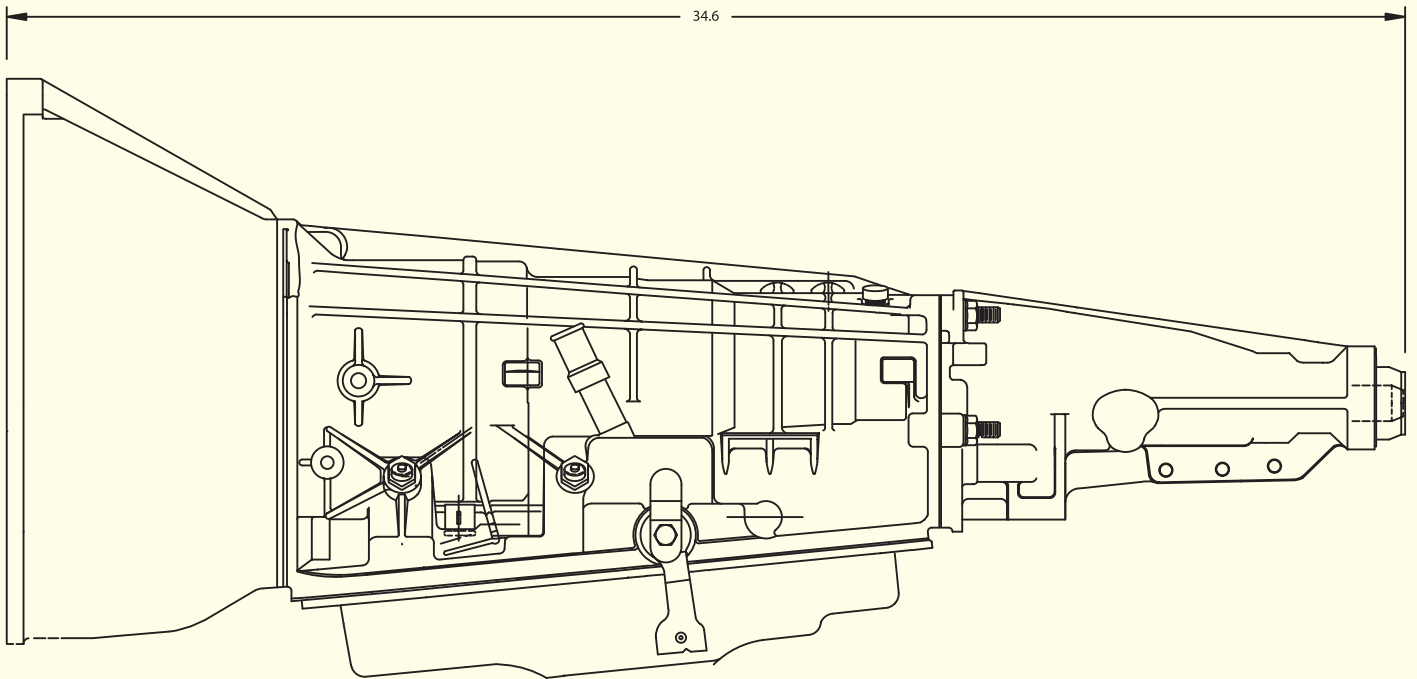

**Left Side View**



**The Source for Power...  
Worldwide™**

Contact Ford Power Products or your local FPP distributor for additional information

**Ford Power Products**  
15700 Lundy Parkway Drive  
Suite 200  
Dearborn, Michigan 48126  
Phone: 1-800-833-4773  
Fax: 1-313-619-2600

**Ford Power Products GmbH**  
Stolberger Str. 313  
D-50933 Köln, Germany  
Phone: 49-221-94700-551  
Fax: 49-221-94700-560

**Ford Power Products Ltd.**  
20/586 Arisdale Avenue  
South Ockendon  
Essex, RM 15 5TJ England  
Phone: 44-1708-672-678  
Fax: 44-1708-672-349

Specifications may vary with application and are subject to change without notice.